

# SWORKE®

**PUSH YOUR LIMIT**

**SPORTS SUNGLASS**

**USER INSTRUCTIONS**

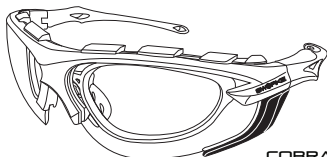

**COBRA  
SWK3053**

## FEATURES

For uncompromised eye protection and style, choose only **SWORKE®**.



**99.9% UV Protection**  
protects your eyes



**Prescription Insert frame**  
for individuals who need corrective lens



**Adjustable Inclination**  
for universal fit



**Interchangeable Lens**  
for different applications



**Anti-Slip Skull Grip**  
for secure and comfort fit



**Scratch-Resistant**  
hard coat withstands wear and tear



**Air Vents for Aeration**  
provide maximum comfort



**Browguard**  
shields your eyes against debris and cushions impact



**Adjustable Nose Pads**  
customised fitting for nose bridges



**Anti-Fog Coating\***  
for optimum clarity

\*For selected lens(es) only

## LENS REMOVAL

- ① Lift the nose pad
- ② Pull out the prescription (Rx) insert gently
- ③ Fold the temples, and slide the fang\* outwards
- ④ Repeat step 3 to the other fang\*
- ⑤ With an outward and downward motion, pull out the inner end of the lens
- ⑥ Repeat step 5 to the other lens

\*For lenses with integrated cheek coverage, skip steps 3 & 4. Fangs are not required with this lens.

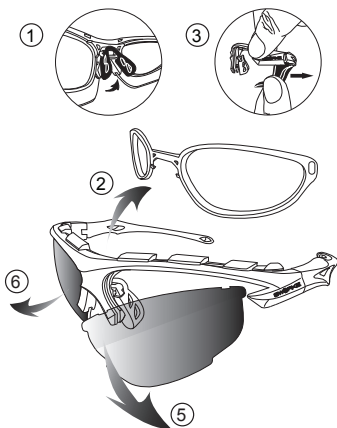

## LENS INSERTION

- ① Firmly grip the hinge of the frame, slot in the outer end of the lens into the hinge slot
- ② Slot in the inner end of the same lens into the nose pad slot. Squeeze the lens and the frame together until you feel a click
- ③ Repeat steps 1 and 2 to other lens
- ④ Fold the temple, then slide the fang† inwards, aligning with the lens
- ⑤ Repeat step 4 to the other fang†
- ⑥ Push in the prescription (Rx) insert into the slots until you hear a click

†For lenses with integrated cheek coverage, skip steps 4 & 5. Fangs are not required with this lens.

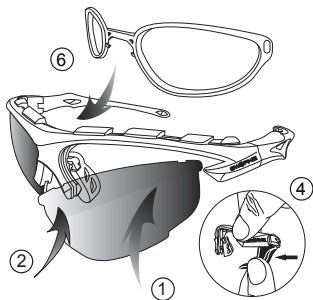

### NOTE

The lens(es) may require a little effort to remove. This is because they are meant to fit tightly into the frame.